

alan johnson design, llc

700 w. 47th st. #200
kansas city, missouri 64112
w 816.412.8455
e alan@alanjohnsondesign.com

architecture
interiors
planning
consulting

an as-built for:
Congleton Distribution #1
090 Bond St.
Lenexa, Kansas

DATE
08.30.12
DRAWN BY
tab
CHECKED BY
awj
REVISIONS

NO.	DESCRIPTION	DATE

SHEET NUMBER

A1

DRAWING TYPE
exist. conditions

CAD FILE
Congleton Distribution

PROJECT NUMBER
9035-66

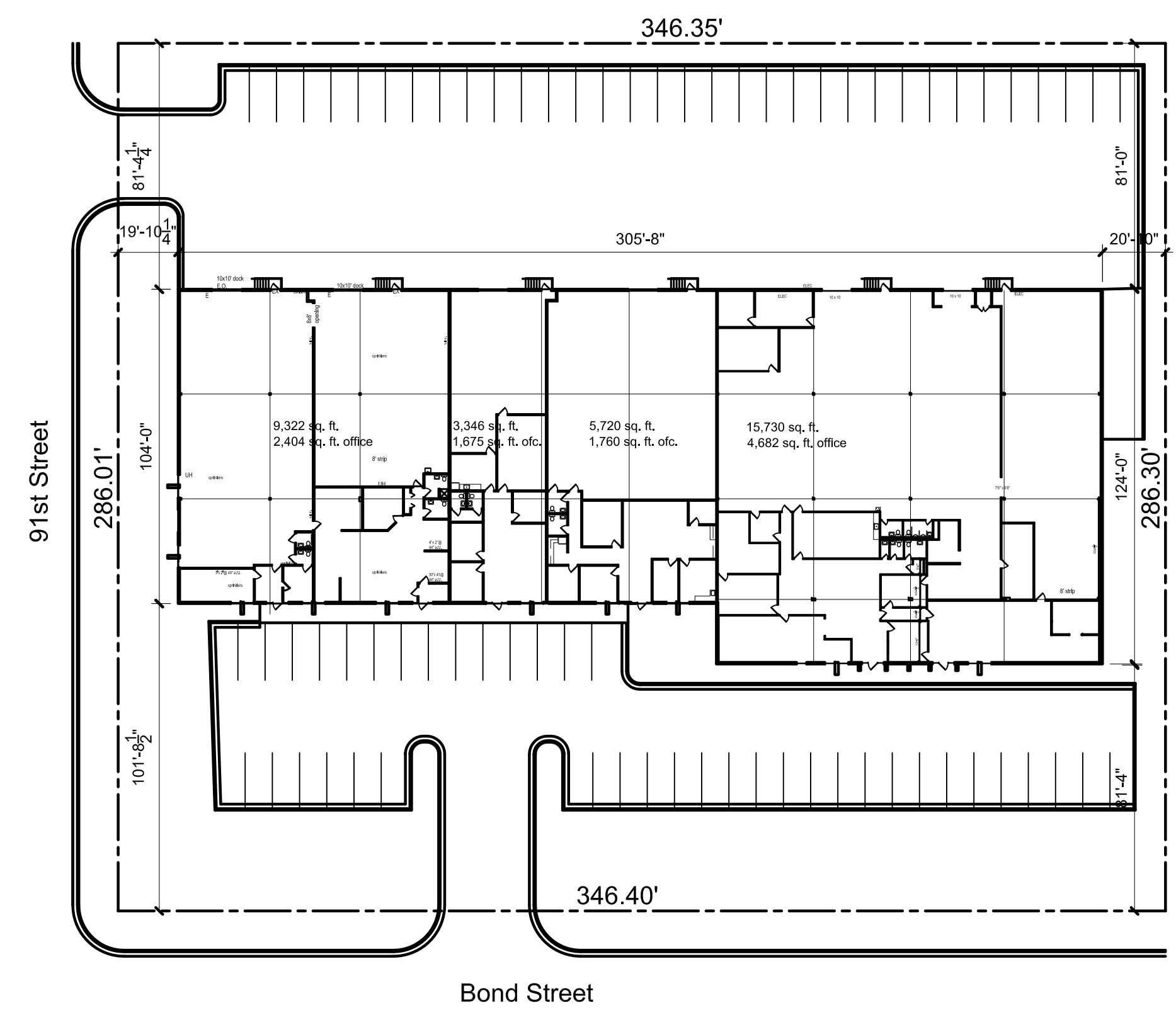

Bond Street

2 site plan
scale: 1" = 40'
north

**New Frontier Technologies
Existing Floor Plan**

All Finishes in office are to be removed.
Warehouse area - electrical, mechanical, fire riser, and demising walls to remain.

- Existing Partitions to remain —
- Existing modular partition. Remove and fur out new drywall —

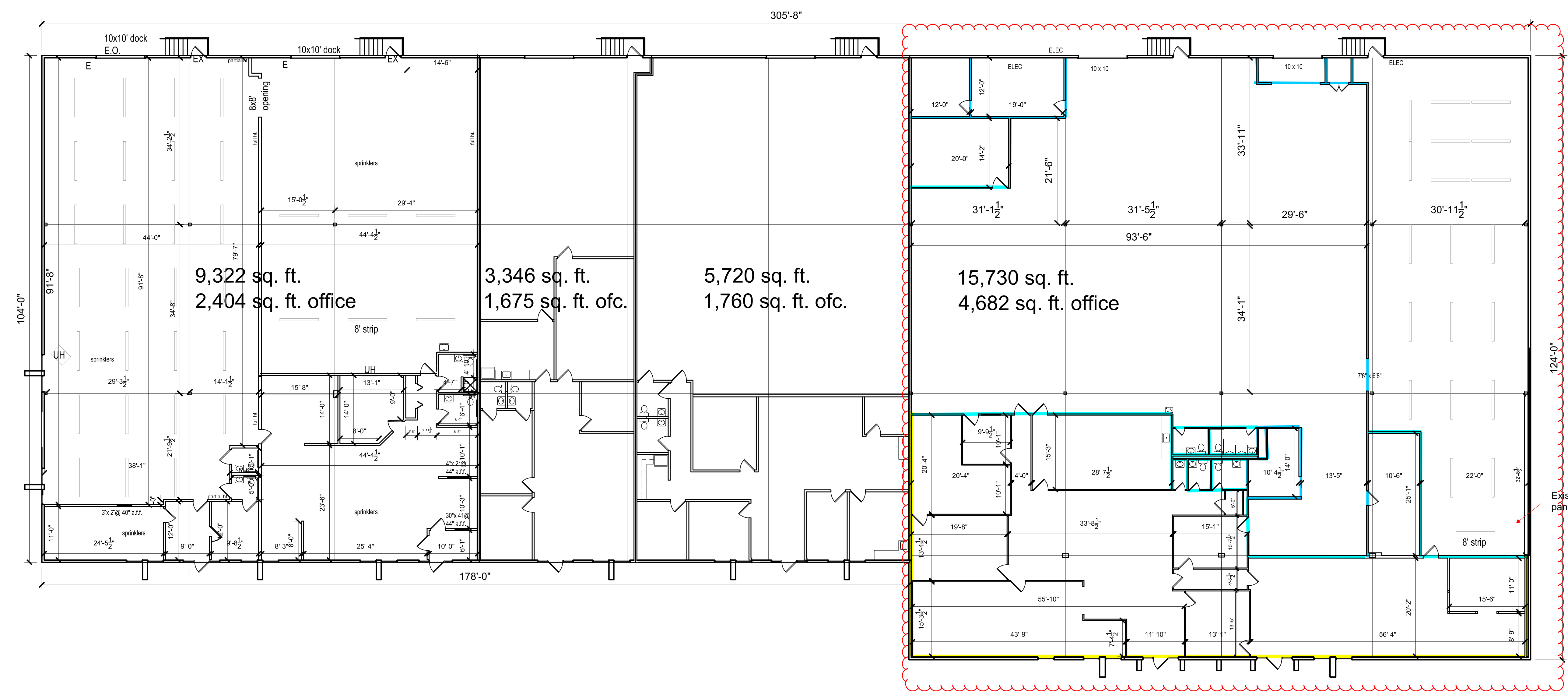

1 key plan
scale: 3/32"=1'
north